

**SITE BOUNDARY SHOWING THE PROP. RESIDENTIAL CUM COMMERCIAL BUILDING B+G+5 OF SRI BROJENDRA MOHAN MAZUMDER ,S/O. LATE NABANI DHAR MAZUMDER , TO BE CONSTRUCTED AT RADHANAGAR ROAD . MOUZA- SANTA. J.L.NO.20 P.S.- HIRAPUR, WARD NO. - 54, R.S. PLOT NO.- 2734 ,L.R PLOT NO - 2494 ,L.R.KHATIAN NO. 1897, DIST: PASCHIM BARDHAMAN ,UNDER ASANSOL MUNICIPAL CORPORATION .**

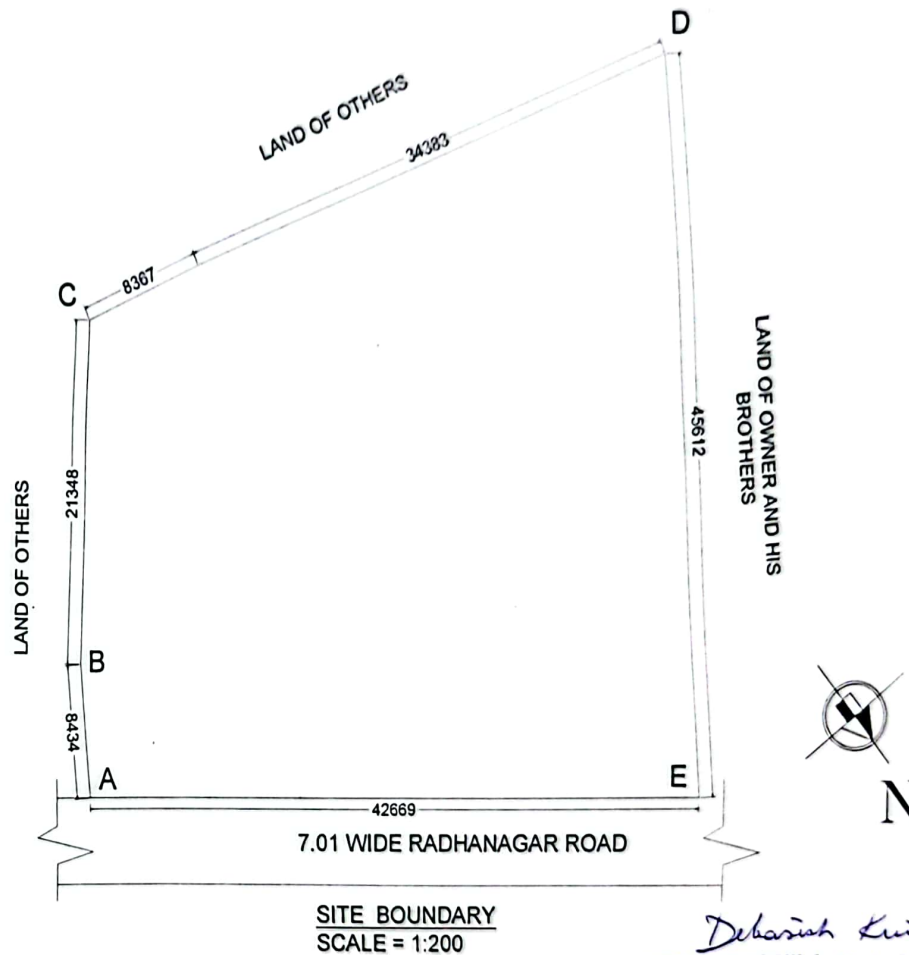

LATITUDE AND LONGITUDE OF END POINTS

A- 23°41'11" N , 86°56'24" E  
 B- 23°41'11" N , 86°56'23" E  
 C- 23°41'10" N , 86°56'23" E  
 D- 23°41'11" N , 86°56'22" E  
 E- 23°41'12" N , 86°56'23" E

ALL MEASUREMENTS IN MILLIMETRES

*Brojendra Mohan Mazumder*  
 SIGNATURE OF THE OWNER

*Debasish Kuila*  
**DEBASISH KUILA, (B. Arch.)**  
 Registered Architect  
 Council of Architecture  
 (Regn. No.-CA/2021/135798)  
 Mob.- 9932801279

SIGNATURE OF THE ARCHITECT